



SCIENTIFICALLY
ADVANCED
INTERIORS

LOWFLOW HOOD



F-350 Isolator³ Gen-5 High Performance Bench Hood

F-350 Isolator³ Gen-5 High Performance Fume Hood - Frameless Sash

ISOLATOR³ Bench Fume Hood - The high performance fume hood is designed with energy conservation in mind, and is ideally suited for environments in which less volume of air is desired. The ICI fume hood has been independently tested and proven to perform at face velocities at between 60 and 63 fpm without auxiliary devices using a Modified ASHRAE test as opposed to the traditional 100FPM. Hoods are cross-draft tested at a constant 58 FPM. This test places the hood under extreme conditions beyond normal ASHRAE testing protocol. Designed to mount on a 31" deep countertop. The ISOLATOR³ fume hood is supplied with the following standard features:

Counter Balance Systems - Chain and sprocket system delivers the easiest and most reliable sash operation available with an exceptional product life-cycle. ISOLATOR drive system provides economical and reliable operation; tested to over 1 million cycles with no failure.

Sash Design - 1/4" thick tempered safety glass is provided with an epoxy urethane coated steel handle. Optional laminated safety glass or polycarbonate available for special applications. Hood has a frameless vertical sash with a 42" exterior sightline.

Lower Airfoil - Aerodynamic flush sill design allows air to enter the fume hood even when the sash is closed ensuring efficient fume exhaust. The flip up safety trough cover allows electrical wiring or tubing into the fume hood while still permitting full closure of the sash.

Stainless Steel Type 304 Exhaust Collar - Round collar which allows for direct connection to typical exhaust ducts to reduce duct transition costs, minimize static pressure losses and exhaust noise levels.

Electrical - Two UL/CSA approved duplex receptacles provided for 120 volt service, one on each corner post. UL/CSA approved LED light fixture and switch provided. Explosion proof fixtures are available options.

Plumbing - Both corner posts are pre-punched to accept a maximum of five plumbing fittings per post. Factory pre-plumbing is available as well as plumbing fixtures from a variety of manufacturers to meet most plumbing needs.

Access Panels - Interior overlay style access panels provide convenient access and prevent accidental removal. Exterior side panels are also removable for ease of access to plumbing and electrical service fixtures.

Standards - UL 1805 Classified and tested in accordance with ASHRAE 110. Test results available upon request.

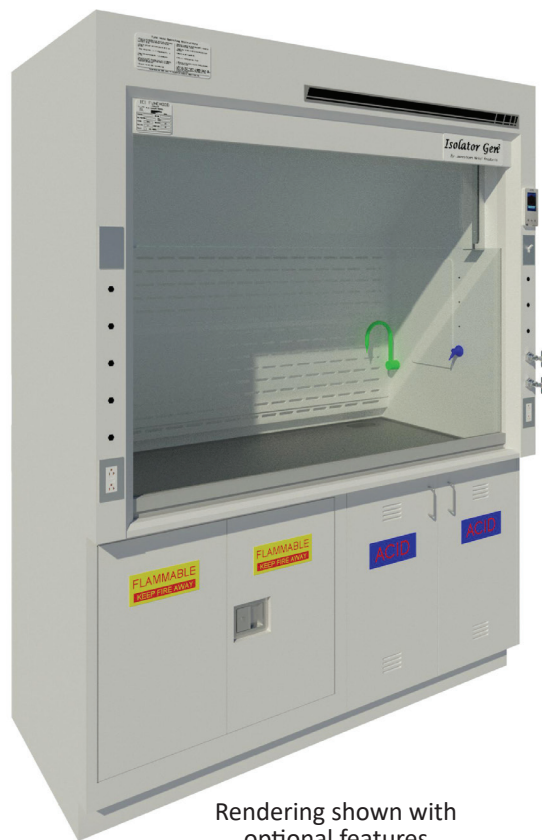

Rendering shown with optional features

Catalog Number	Width	Clear Interior Depth	Duct Diameter	24" Vertical Open @ 60 FPM	18" Vertical Open @ 80 FPM
F-350-48G5	48"	24"	1:12"	380 CFM @ .12" SP	380 CFM @ .12" SP
F-350-60G5	60"	24"	1:12"	500 CFM @ .11" SP	500 CFM @ .11" SP
F-350-72G5	72"	24"	1:12"	620 CFM @ .17" SP	620 CFM @ .17" SP
F-350-84G5	84"	24"	1:12"	740 CFM @ .20" SP	740 CFM @ .20" SP
F-350-96G5	96"	24"	2:12"	860 CFM @ .15" SP	860 CFM @ .15" SP

F-350 Isolator³ Gen-5 High Performance Bench Hood

F-350-48G5 - 48" Wide

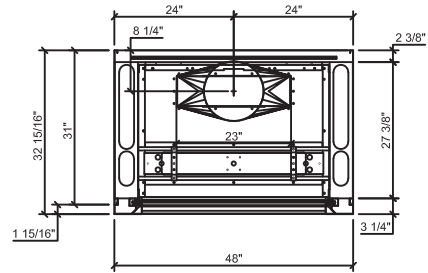
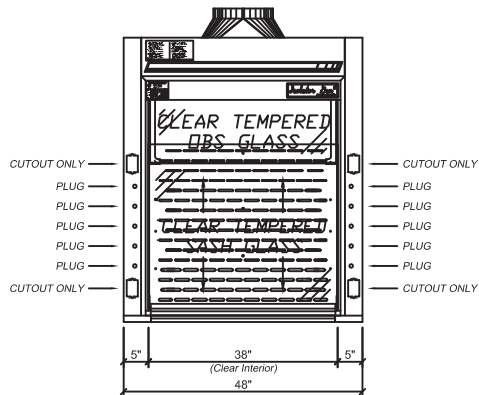

F-350-60G5 - 60" Wide

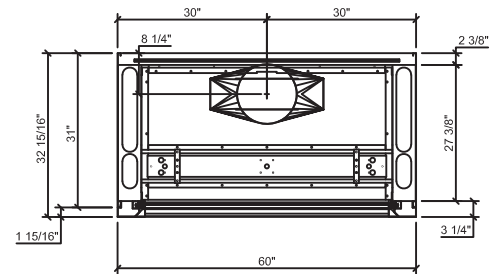
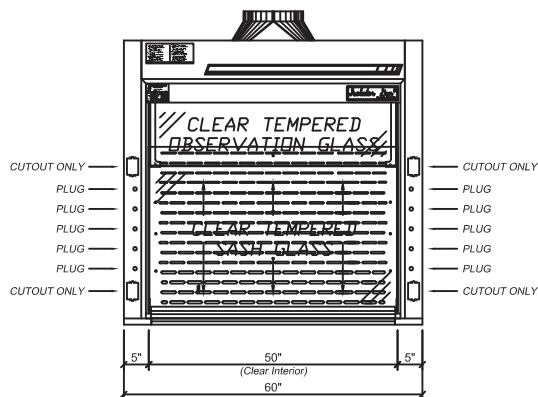

F-350-72G5 - 72" Wide

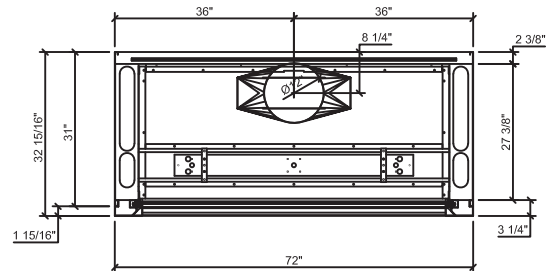
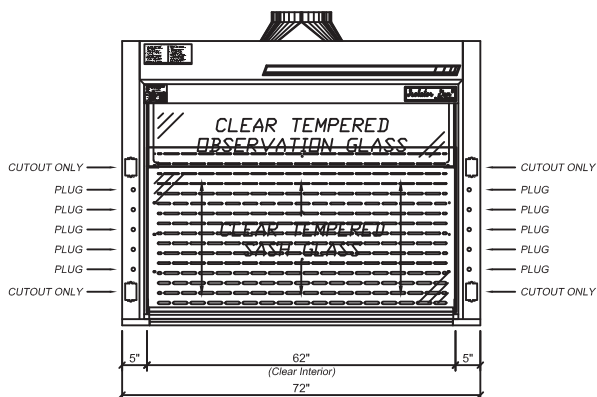

F-350 Isolator³ Gen-5 High Performance Bench Hood

F-350-84G5 - 84" Wide

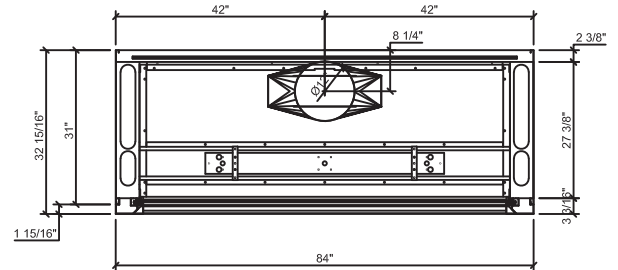
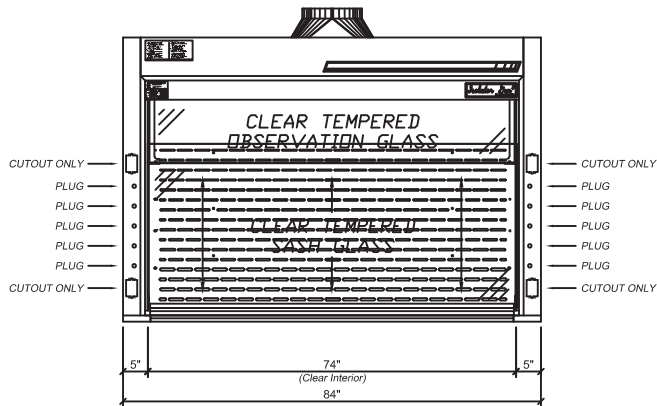

F-350-96G5 - 96" Wide

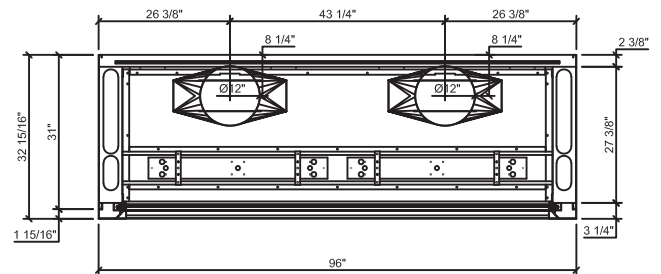
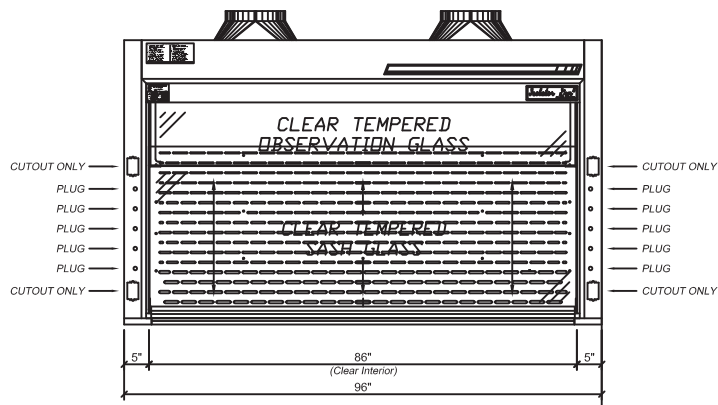

Section - Standard Depth

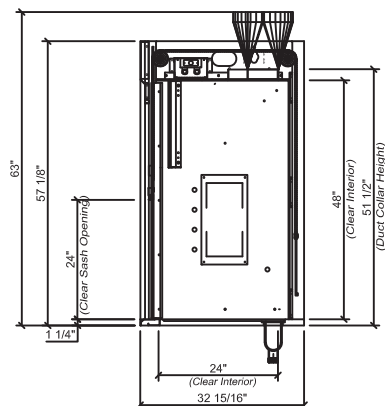

F-350 Isolator³ Gen-5 ADA High Performance Bench Hood

F-350 Isolator³ Gen-5 ADA High Performance Fume Hood - Frameless Sash

ISOLATOR³ ADA Bench Fume Hood - The high performance fume hood is designed with energy conservation in mind, and is ideally suited for environments in which less volume of air is desired. The ICI fume hood has been independently tested and proven to perform at face velocities at between 60 and 63 FPM without auxiliary devices using a Modified ASHRAE test as opposed to the traditional 100FPM. Hoods are cross-draft tested at a constant 58 FPM. This test places the hood under extreme conditions beyond normal ASHRAE testing protocol. Designed to mount on a 31" deep countertop. The ISOLATOR³ fume hood is supplied with the following standard features:

Counter Balance Systems - Chain and sprocket system delivers the easiest and most reliable sash operation available with an exceptional product life-cycle. ISOLATOR drive system provides economical and reliable operation; tested to over 1 million cycles with no failure.

Sash Design - 1/4" thick tempered safety glass is provided with an epoxy urethane coated steel handle. Optional laminated safety glass or polycarbonate available for special applications. Hood has a frameless vertical sash with a 42" exterior sightline.

Lower Airfoil - Aerodynamic flush sill design allows air to enter the fume hood even when the sash is closed ensuring efficient fume exhaust. The flip up safety trough cover allows electrical wiring or tubing into the fume hood while still permitting full closure of the sash.

Stainless Steel Type 304 Exhaust Collar - Round collar which allows for direct connection to typical exhaust ducts to reduce duct transition costs, minimize static pressure losses and exhaust noise levels.

Electrical - Two UL/CSA approved duplex receptacles provided for 120 volt service, one on each corner post. UL/CSA approved LED light fixture and switch provided. Explosion proof fixtures are available options.

Plumbing - Both corner posts are pre-punched to accept a maximum of one plumbing fitting per post. Factory pre-plumbing is available as well as plumbing fixtures from a variety of manufacturers to meet most plumbing needs.

Access Panels - Interior overlay style access panels provide convenient access and prevent accidental removal. Exterior side panels are also removable for ease of access to plumbing and electrical service fixtures.

Standards - UL 1805 Classified and tested in accordance with ASHRAE 110. Test results available upon request.

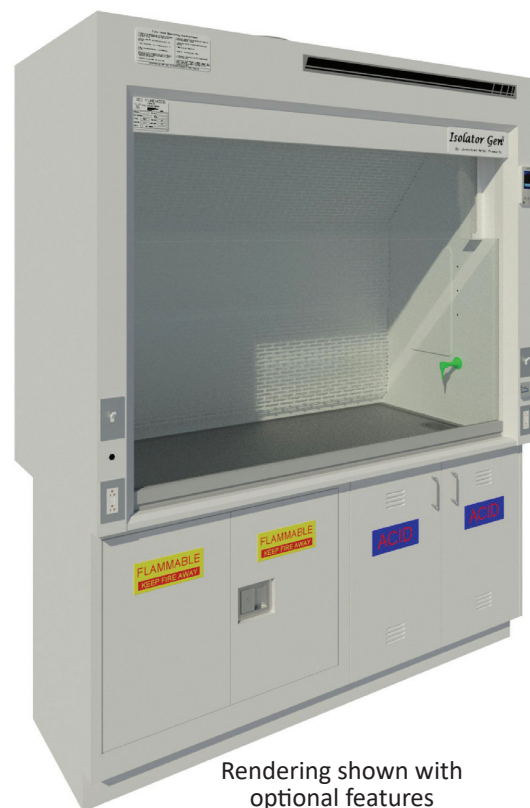

Rendering shown with optional features

Catalog Number	Width	Clear Interior Depth	Duct Diameter	24" Vertical Open @ 60 FPM	18" Vertical Open @ 80 FPM
F-350-48G5-ADA	48"	24"	1:12"	380 CFM @ .12" SP	380 CFM @ .12" SP
F-350-60G5-ADA	60"	24"	1:12"	500 CFM @ .11" SP	500 CFM @ .11" SP
F-350-72G5-ADA	72"	24"	1:12"	620 CFM @ .17" SP	620 CFM @ .17" SP
F-350-84G5-ADA	84"	24"	1:12"	740 CFM @ .20" SP	740 CFM @ .20" SP
F-350-96G5-ADA	96"	24"	2:12"	860 CFM @ .15" SP	860 CFM @ .15" SP

F-350 Isolator³ Gen-5 ADA High Performance Bench Hood

F-350-48G5-ADA - 48" Wide

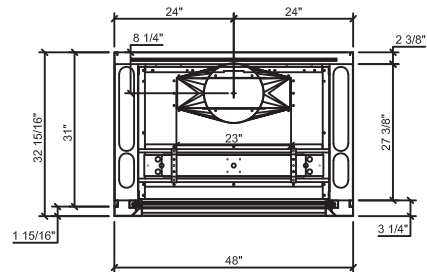
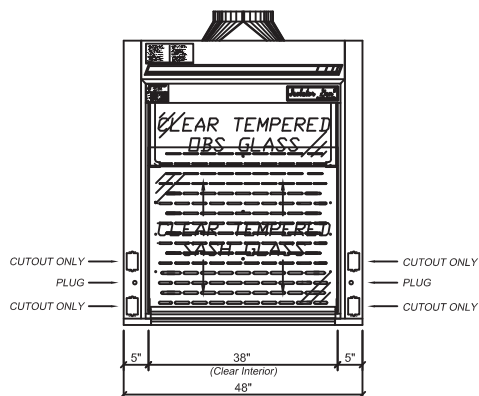

F-350-60G5-ADA - 60" Wide

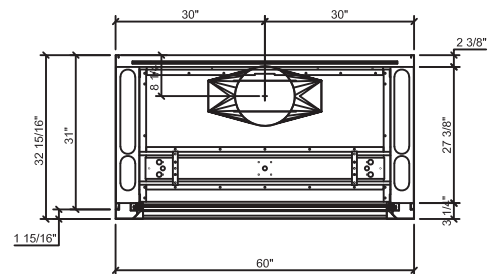
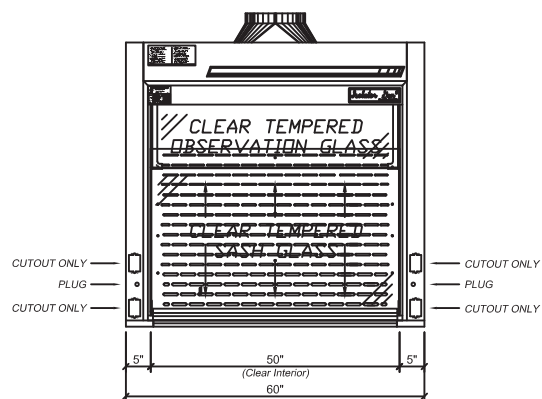

F-350-72G5-ADA - 72" Wide

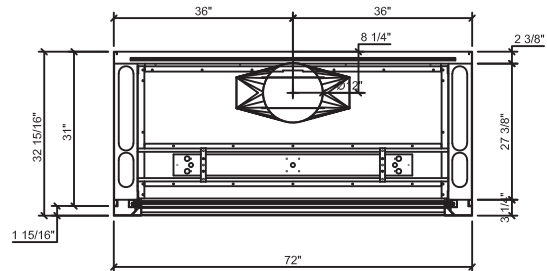
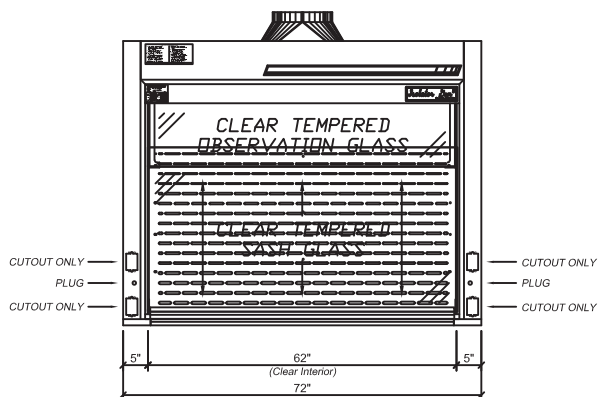

F-350 Isolator³ Gen-5 ADA High Performance Bench Hood

F-350-84G5-ADA - 84" Wide

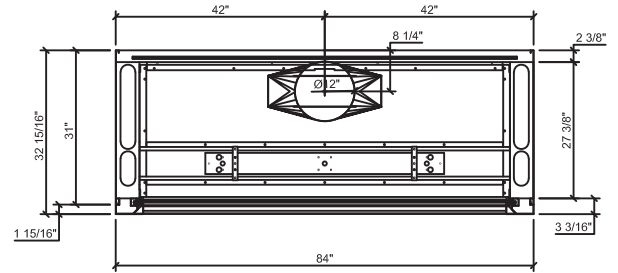
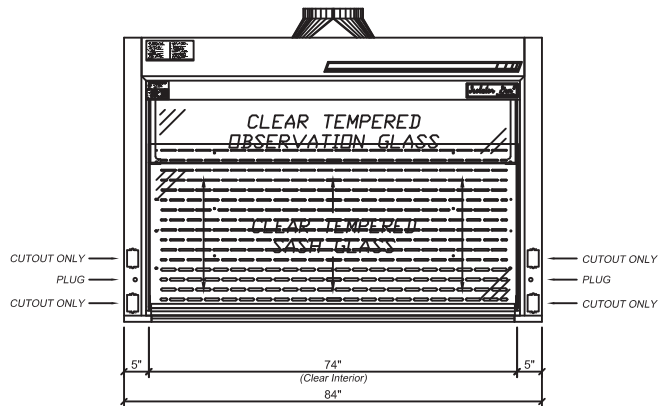

F-350-96G5-ADA - 96" Wide

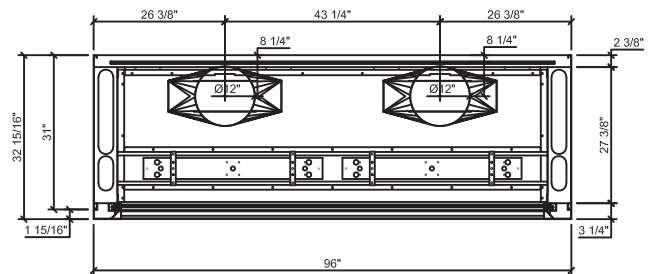
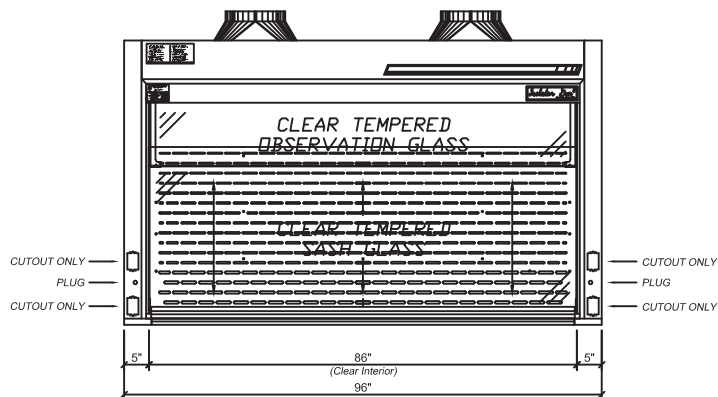

Section - Standard Depth

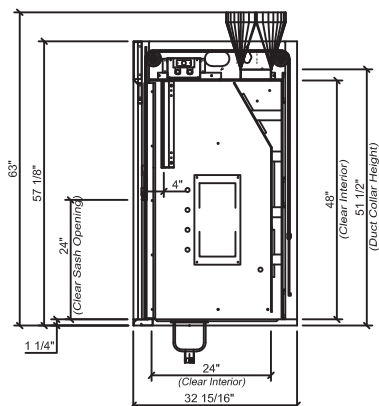

F-351 Isolator³ Gen-5 High Performance Bench Hood

F-351 Isolator³ Gen-5 High Performance Fume Hood - Combination Sash

ISOLATOR³ Bench Fume Hood - The high performance fume hood is designed with energy conservation in mind, and is ideally suited for environments in which less volume of air is desired. The ICI fume hood has been independently tested and proven to perform at face velocities at between 60 and 63 FPM without auxiliary devices using a Modified ASHRAE test as opposed to the traditional 100FPM. Hoods are cross-draft tested at a constant 58 FPM. This test places the hood under extreme conditions beyond normal ASHRAE testing protocol. Designed to mount on a 31" deep countertop. The ISOLATOR³ fume hood is supplied with the following standard features:

Counter Balance Systems - Chain and sprocket system delivers the easiest and most reliable sash operation available with an exceptional product life-cycle. ISOLATOR drive system provides economical and reliable operation; tested to over 1 million cycles with no failure.

Sash Design - 1/4" thick tempered safety panels are provided with a stainless steel sash frame. Optional laminated safety glass or polycarbonate available for special applications. Hood has a framed vertical sash and horizontal panels with a 42" exterior sightline.

Lower Airfoil - Aerodynamic flush sill design allows air to enter the fume hood even when the sash is closed ensuring efficient fume exhaust. The flip up safety trough cover allows electrical wiring or tubing into the fume hood while still permitting full closure of the sash.

Stainless Steel Type 304 Exhaust Collar - Round collar which allows for direct connection to typical exhaust ducts to reduce duct transition costs, minimize static pressure losses and exhaust noise levels.

Electrical - Two UL/CSA approved duplex receptacles provided for 120 volt service, one on each corner post. UL/CSA approved LED light fixture and switch provided. Explosion proof fixtures are available options.

Plumbing - Both corner posts are pre-punched to accept a maximum of five plumbing fittings per post. Factory pre-plumbing is available as well as plumbing fixtures from a variety of manufacturers to meet most plumbing needs.

Access Panels - Interior overlay style access panels provide convenient access and prevent accidental removal. Exterior side panels are also removable for ease of access to plumbing and electrical service fixtures.

Standards - UL 1805 Classified and tested in accordance with ASHRAE 110. Test results available upon request.



Rendering shown with optional features

Catalog Number	Width	Clear Interior Depth	Duct Diameter	24" Vertical Open @ 60 FPM	18" Vertical Open @ 80 FPM	50% Horizontal Open @ 80 FPM
F-351-48G5	48"	24"	1:12"	380 CFM @ .12" SP	380 CFM @ .12" SP	380 CFM @ .12" SP
F-351-60G5	60"	24"	1:12"	500 CFM @ .11" SP	500 CFM @ .11" SP	500 CFM @ .11" SP
F-351-72G5	72"	24"	1:12"	620 CFM @ .17" SP	620 CFM @ .17" SP	620 CFM @ .17" SP
F-351-84G5	84"	24"	1:12"	740 CFM @ .20" SP	740 CFM @ .20" SP	740 CFM @ .20" SP
F-351-96G5	96"	24"	2:12"	860 CFM @ .15" SP	860 CFM @ .15" SP	860 CFM @ .15" SP

F-351 Isolator³ Gen-5 High Performance Bench Hood

F-351-48G5 - 48" Wide

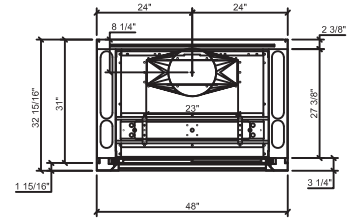
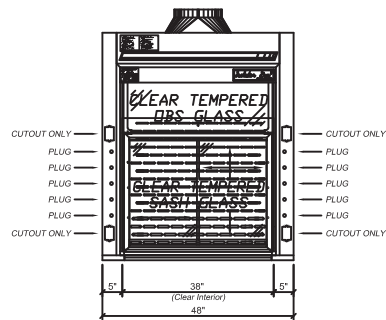

F-351-60G5 - 60" Wide

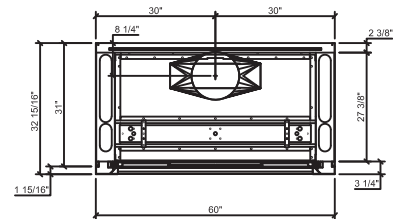
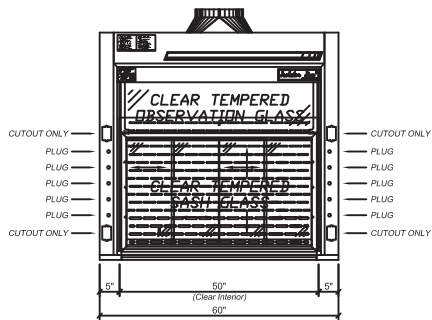

F-351-72G5 - 72" Wide

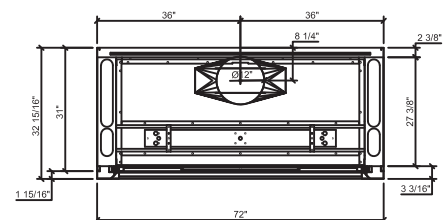
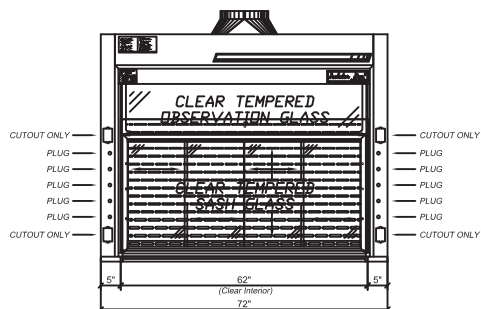

F-351 Isolator³ Gen-5 High Performance Bench Hood

F-351-84G5 - 84" Wide

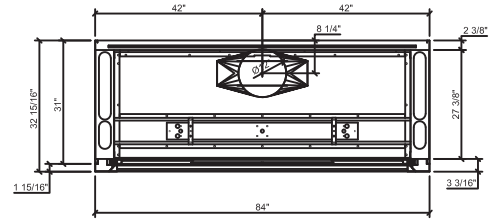
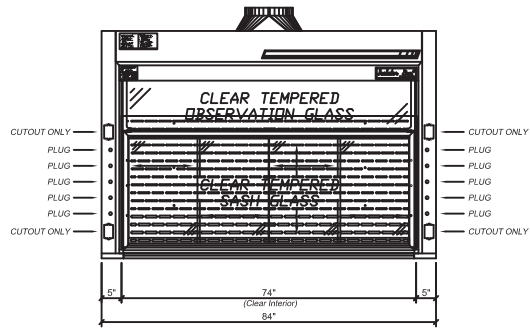

F-351-96G5 - 96" Wide

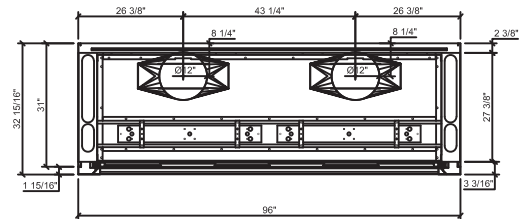
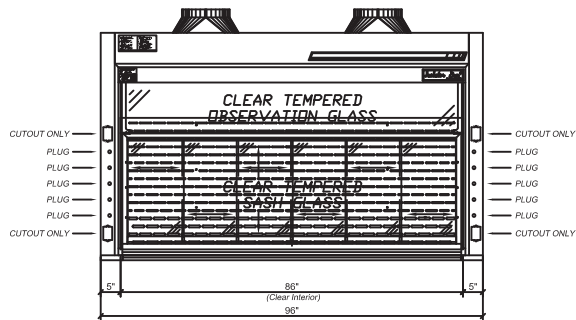

F-351 Isolator³ Gen-5 High Performance Bench Hood

Section - Standard Depth

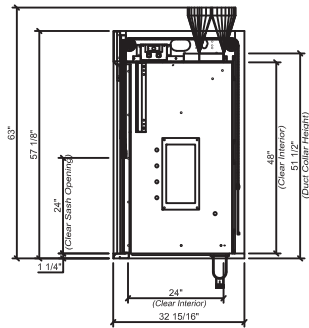

F-351 Isolator³ Gen-5 ADA High Performance Bench Hood

F-351 Isolator³ Gen-5 ADA High Performance Fume Hood - Combination Sash

ISOLATOR³ ADA Bench Fume Hood - The high performance fume hood is designed with energy conservation in mind, and is ideally suited for environments in which less volume of air is desired. The ICI fume hood has been independently tested and proven to perform at face velocities at between 60 and 63 FPM without auxiliary devices using a Modified ASHRAE test as opposed to the traditional 100FPM. Hoods are cross-draft tested at a constant 58 FPM. This test places the hood under extreme conditions beyond normal ASHRAE testing protocol. Designed to mount on a 31" deep countertop. The ISOLATOR³ fume hood is supplied with the following standard features:

Counter Balance Systems - Chain and sprocket system delivers the easiest and most reliable sash operation available with an exceptional product life-cycle. ISOLATOR drive system provides economical and reliable operation; tested to over 1 million cycles with no failure.

Sash Design - 1/4" thick tempered safety panels are provided with a stainless steel sash frame. Optional laminated safety glass or polycarbonate available for special applications. Hood has a framed vertical sash and horizontal panels with a 42" exterior sightline.

Lower Airfoil - Aerodynamic flush sill design allows air to enter the fume hood even when the sash is closed ensuring efficient fume exhaust. The flip up safety trough cover allows electrical wiring or tubing into the fume hood while still permitting full closure of the sash.

Stainless Steel Type 304 Exhaust Collar - Round collar which allows for direct connection to typical exhaust ducts to reduce duct transition costs, minimize static pressure losses and exhaust noise levels.

Electrical - Two UL/CSA approved duplex receptacles provided for 120 volt service, one on each corner post. UL/CSA approved LED light fixture and switch provided. Explosion proof fixtures are available options.

Plumbing - Both corner posts are pre-punched to accept a maximum of one plumbing fitting per post. Factory pre-plumbing is available as well as plumbing fixtures from a variety of manufacturers to meet most plumbing needs.

Access Panels - Interior overlay style access panels provide convenient access and prevent accidental removal. Exterior side panels are also removable for ease of access to plumbing and electrical service fixtures.

Standards - UL 1805 Classified and tested in accordance with ASHRAE 110. Test results available upon request.



Rendering shown with optional features

Catalog Number	Width	Clear Interior Depth	Duct Diameter	24" Vertical Open @ 60 FPM	18" Vertical Open @ 80 FPM	50% Horizontal Open @ 80 FPM
F-351-48G5-ADA	48"	24"	1:12"	380 CFM @ .12" SP	380 CFM @ .12" SP	380 CFM @ .12" SP
F-351-60G5-ADA	60"	24"	1:12"	500 CFM @ .11" SP	500 CFM @ .11" SP	500 CFM @ .11" SP
F-351-72G5-ADA	72"	24"	1:12"	620 CFM @ .17" SP	620 CFM @ .17" SP	620 CFM @ .17" SP
F-351-84G5-ADA	84"	24"	1:12"	740 CFM @ .20" SP	740 CFM @ .20" SP	740 CFM @ .20" SP
F-351-96G5-ADA	96"	24"	2:12"	860 CFM @ .15" SP	860 CFM @ .15" SP	860 CFM @ .15" SP

F-351 Isolator³ Gen-5 ADA High Performance Bench Hood

F-351-48G5-ADA - 48" Wide

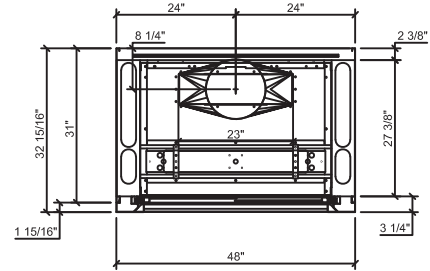
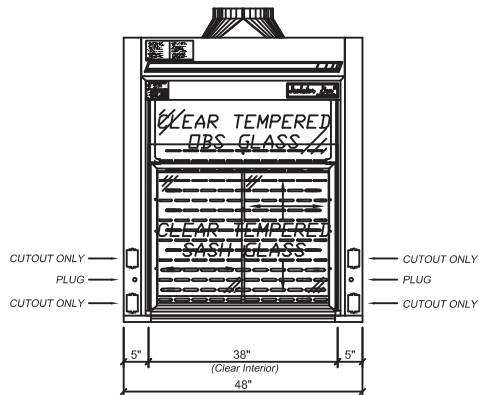

F-351-60G5-ADA - 60" Wide

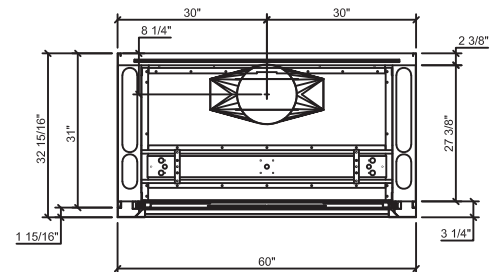
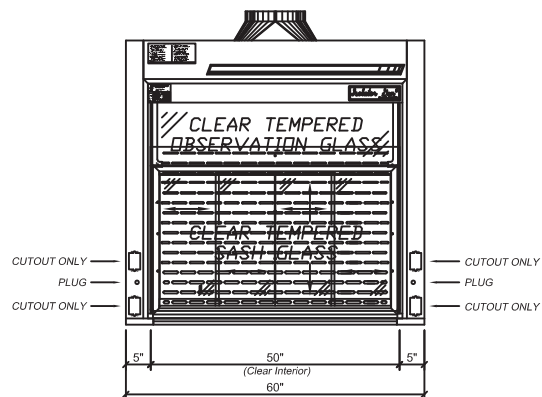

F-351-72G5-ADA - 72" Wide

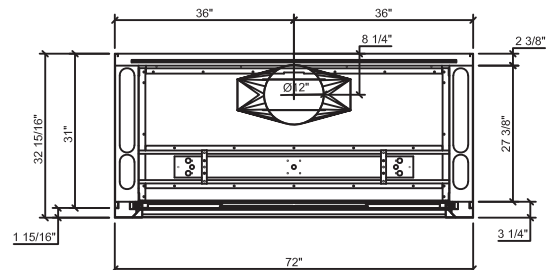
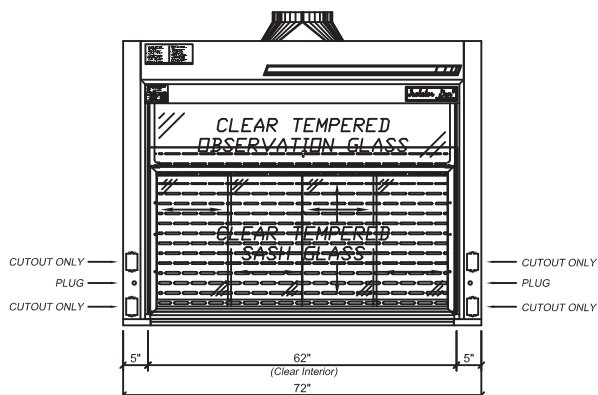

F-351 Isolator³ Gen-5 ADA High Performance Bench Hood

F-351-84G5-ADA - 84" Wide

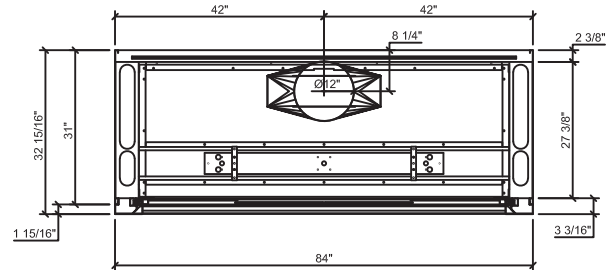
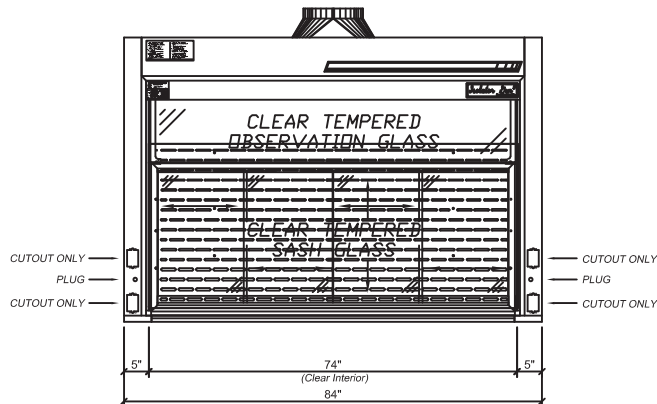

F-351-96G5-ADA - 96" Wide

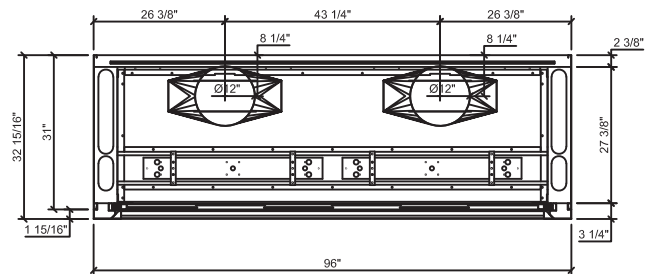
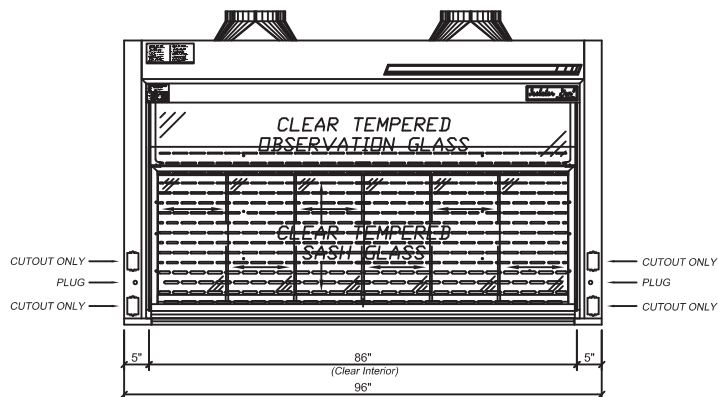

Section - Standard Depth

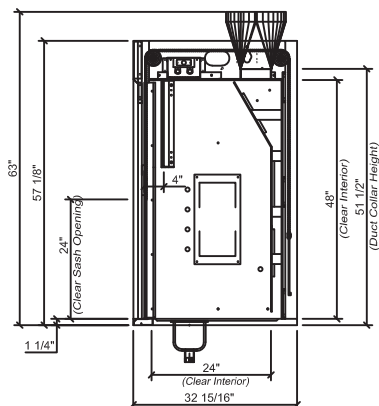

F-353 Gen-5 High Performance Bench Hood

F-353 Isolator Gen-5 High Performance Fume Hood - Framed Sash

ISOLATOR³ Bench Fume Hood - The high performance fume hood is designed with energy conservation in mind, and is ideally suited for environments in which less volume of air is desired. The ICI fume hood has been independently tested and proven to perform at face velocities at between 60 and 63 FPM without auxiliary devices using a Modified ASHRAE test as opposed to the traditional 100FPM. Hoods are cross-draft tested at a constant 58 FPM. This test places the hood under extreme conditions beyond normal ASHRAE testing protocol. Designed to mount on a 31" deep countertop. The ISOLATOR³ fume hood is supplied with the following standard features:

Counter Balance Systems - Chain and sprocket system delivers the easiest and most reliable sash operation available with an exceptional product life-cycle. ISOLATOR drive system provides economical and reliable operation; tested to over 1 million cycles with no failure.

Sash Design - 1/4" thick tempered safety glass is provided with an epoxy urethane coated steel handle. Optional laminated safety glass or polycarbonate available for special applications. Hood has a frameless vertical sash with a 42" exterior sightline.

Lower Airfoil - Aerodynamic flush sill design allows air to enter the fume hood even when the sash is closed ensuring efficient fume exhaust. The flip up safety trough cover allows electrical wiring or tubing into the fume hood while still permitting full closure of the sash.

Stainless Steel Type 304 Exhaust Collar - Round collar which allows for direct connection to typical exhaust ducts to reduce duct transition costs, minimize static pressure losses and exhaust noise levels.

Electrical - Two UL/CSA approved duplex receptacles provided for 120 volt service, one on each corner post. UL/CSA approved LED light fixture and switch provided. Explosion proof fixtures are available options.

Plumbing - Both corner posts are pre-punched to accept a maximum of five plumbing fittings per post. Factory pre-plumbing is available as well as plumbing fixtures from a variety of manufacturers to meet most plumbing needs.

Access Panels - Interior overlay style access panels provide convenient access and prevent accidental removal. Exterior side panels are also removable for ease of access to plumbing and electrical service fixtures.

Standards - UL 1805 Classified and tested in accordance with ASHRAE 110. Test results available upon request.



Rendering shown with optional features

Catalog Number	Width	Clear Interior Depth	Duct Diameter	24" Vertical Open @ 60 FPM	18" Vertical Open @ 80 FPM
F-353-48G5	48"	24"	1:12"	380 CFM @ .12" SP	380 CFM @ .12" SP
F-353-60G5	60"	24"	1:12"	500 CFM @ .11" SP	500 CFM @ .11" SP
F-353-72G5	72"	24"	1:12"	620 CFM @ .17" SP	620 CFM @ .17" SP
F-353-84G5	84"	24"	1:12"	740 CFM @ .20" SP	740 CFM @ .20" SP
F-353-96G5	96"	24"	2:12"	860 CFM @ .15" SP	860 CFM @ .15" SP

F-353 Gen-5 High Performance Bench Hood

F-353-48G5 - 48" Wide

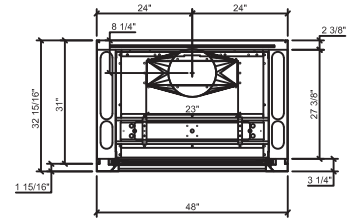
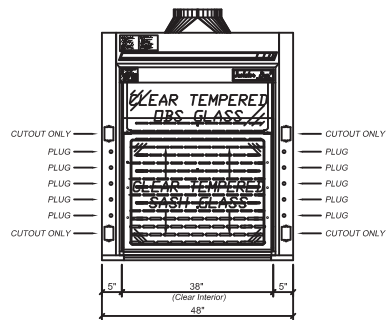

F-353-60G5 - 60" Wide

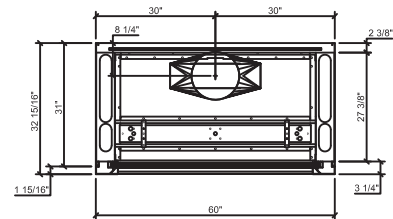
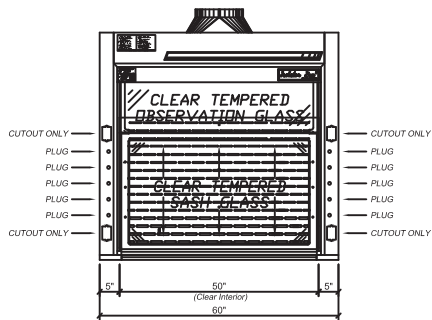

F-353-72G5 - 72" Wide

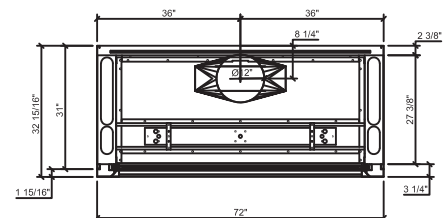
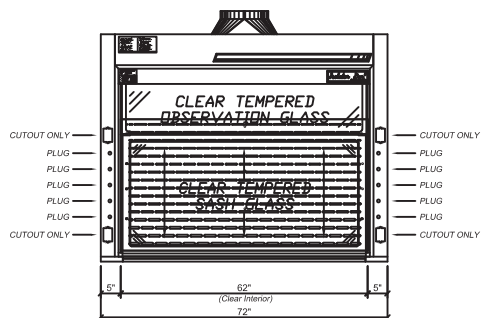

F-353 Gen-5 High Performance Bench Hood

F-353-84G5 - 84" Wide

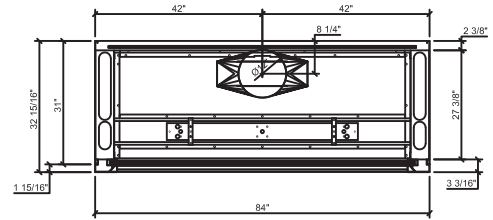
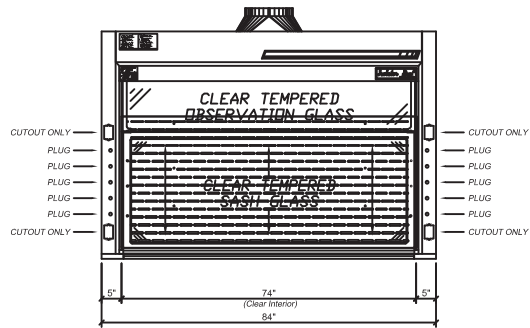

F-353-96G5 - 96" Wide

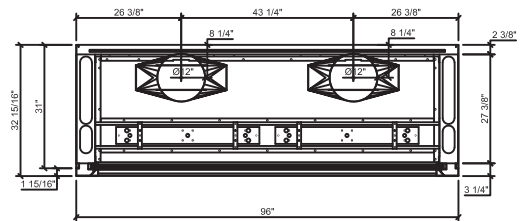
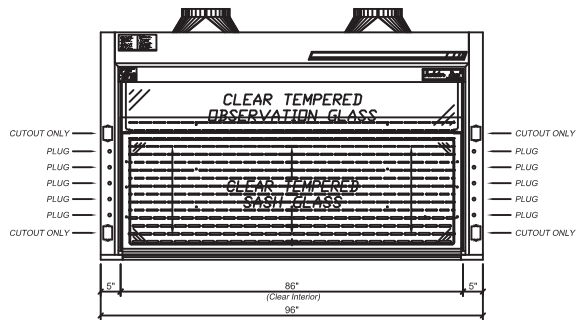

Section - Standard Depth

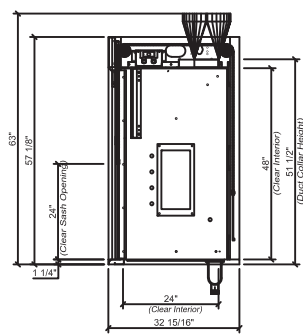

F-353 Gen-5 ADA High Performance Bench Hood

F-353 Isolator Gen-5 ADA High Performance Fume Hood - Framed Sash

ISOLATOR³ ADA Bench Fume Hood - The high performance fume hood is designed with energy conservation in mind, and is ideally suited for environments in which less volume of air is desired. The ICI fume hood has been independently tested and proven to perform at face velocities at between 60 and 63 FPM without auxiliary devices using a Modified ASHRAE test as opposed to the traditional 100FPM. Hoods are cross-draft tested at a constant 58 FPM. This test places the hood under extreme conditions beyond normal ASHRAE testing protocol. Designed to mount on a 31" deep countertop. The ISOLATOR³ fume hood is supplied with the following standard features:

Counter Balance Systems - Chain and sprocket system delivers the easiest and most reliable sash operation available with an exceptional product life-cycle. ISOLATOR drive system provides economical and reliable operation; tested to over 1 million cycles with no failure.

Sash Design - 1/4" thick tempered safety glass is provided with an epoxy urethane coated steel handle. Optional laminated safety glass or polycarbonate available for special applications. Hood has a frameless vertical sash with a 42" exterior sightline.

Lower Airfoil - Aerodynamic flush sill design allows air to enter the fume hood even when the sash is closed ensuring efficient fume exhaust. The flip up safety trough cover allows electrical wiring or tubing into the fume hood while still permitting full closure of the sash.

Stainless Steel Type 304 Exhaust Collar - Round collar which allows for direct connection to typical exhaust ducts to reduce duct transition costs, minimize static pressure losses and exhaust noise levels.

Electrical - Two UL/CSA approved duplex receptacles provided for 120 volt service, one on each corner post. UL/CSA approved LED light fixture and switch provided. Explosion proof fixtures are available options.

Plumbing - Both corner posts are pre-punched to accept a maximum of one plumbing fitting per post. Factory pre-plumbing is available as well as plumbing fixtures from a variety of manufacturers to meet most plumbing needs.

Access Panels - Interior overlay style access panels provide convenient access and prevent accidental removal. Exterior side panels are also removable for ease of access to plumbing and electrical service fixtures.

Standards - UL 1805 Classified and tested in accordance with ASHRAE 110. Test results available upon request.

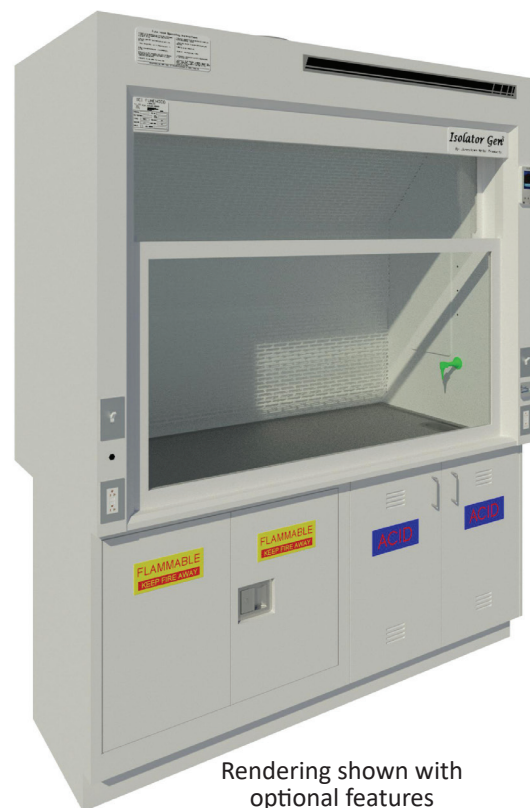

Rendering shown with optional features

Catalog Number	Width	Clear Interior Depth	Duct Diameter	24" Vertical Open @ 60 FPM	18" Vertical Open @ 80 FPM
F-353-48G5-ADA	48"	24"	1:12"	380 CFM @ .12" SP	380 CFM @ .12" SP
F-353-60G5-ADA	60"	24"	1:12"	500 CFM @ .11" SP	500 CFM @ .11" SP
F-353-72G5-ADA	72"	24"	1:12"	620 CFM @ .17" SP	620 CFM @ .17" SP
F-353-84G5-ADA	84"	24"	1:12"	740 CFM @ .20" SP	740 CFM @ .20" SP
F-353-96G5-ADA	96"	24"	2:12"	860 CFM @ .15" SP	860 CFM @ .15" SP

F-353 Gen-5 ADA High Performance Bench Hood

F-353-48G5-ADA - 48" Wide

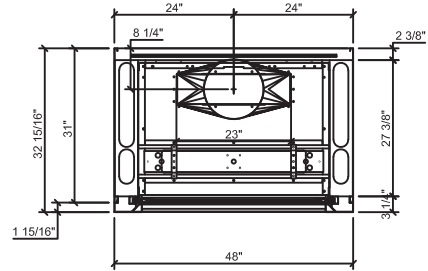
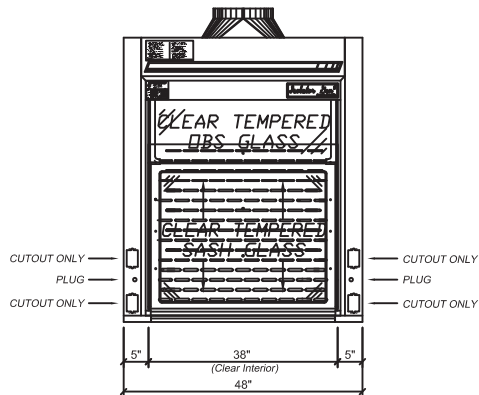

F-353-60G5-ADA - 60" Wide

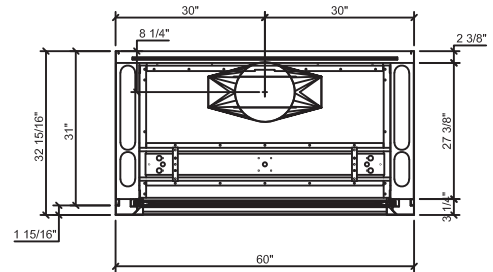
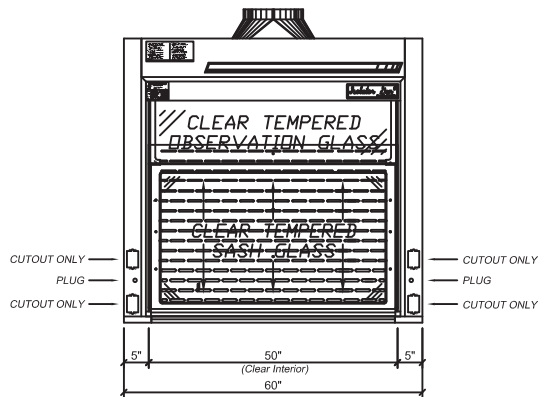

F-353-72G5-ADA - 72" Wide

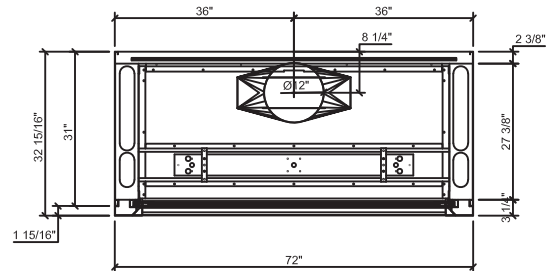
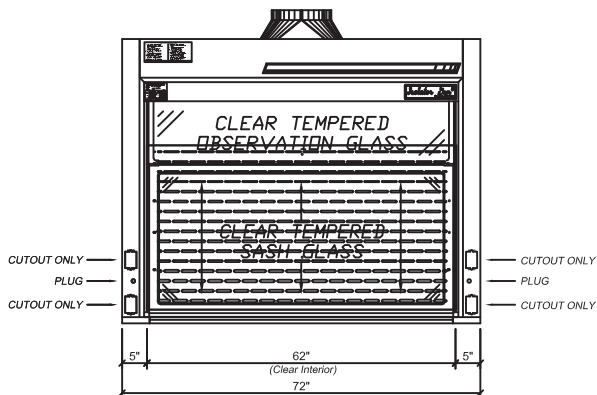

F-353 Gen-5 ADA High Performance Bench Hood

F-353-84G5-ADA - 84" Wide

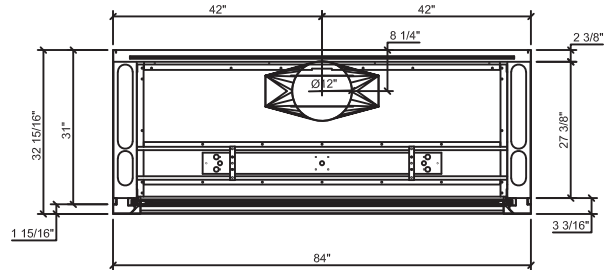
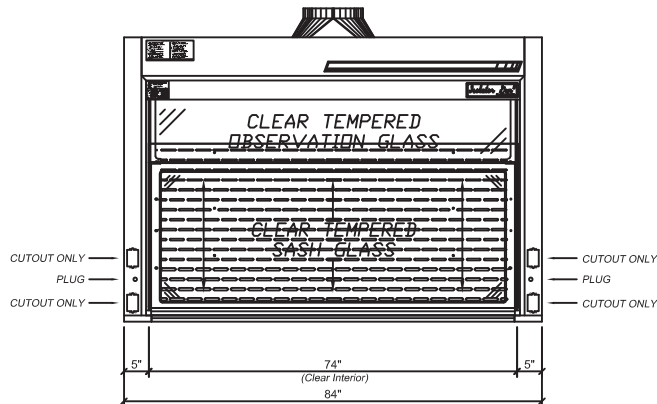

F-353-96G5-ADA - 96" Wide

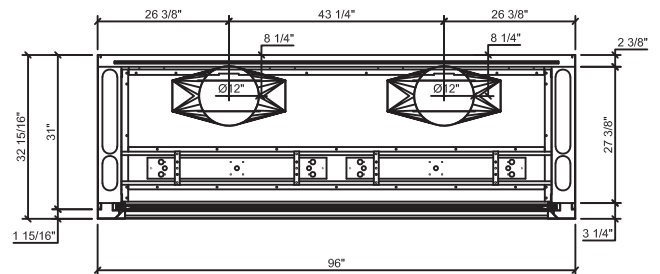
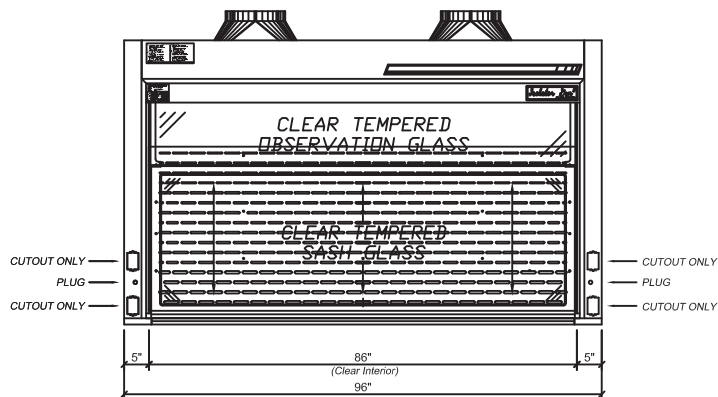

Section - Standard Depth

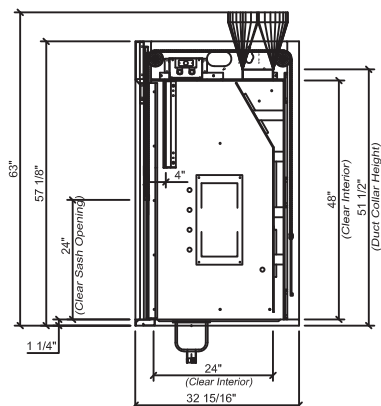



SAI SYSTEMS

Scientifically Advanced Interiors

Toll Free: (866) 527-2970

sales@saisns.com

www.saisns.com

BURNABY

TORONTO

HALIFAX